

EXTERIOR ELEVATION

NOT TO SCALE

~ SOLAR INNOVATIONS' ALL WALL SYSTEM ~

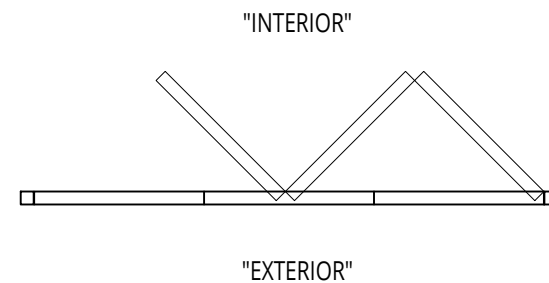

PLAN VIEW

NOT TO SCALE

UNIT INFORMATION

FRAMING TYPE: G2 Narrow NonThermal Framing

GLAZING SET UP: Opening for $\frac{3}{16}$ " Monolithic Glazing to $1\frac{1}{4}$ " Insulated Glazing, Polycarbonate, or Solid Panel Infill

Top or Bottom Weight Bearing

Zero Maintenance Extruded Aluminum Hinges with Stainless Steel Pin

Minimum Horizontal Panel Dimension 18". Smaller Panels may be available upon Engineering Approval

Designed and Manufactured in the U.S.A.

© 2017 Solar Innovations, Inc. - All Rights Reserved. These plans are the property of Solar Innovations, Inc. Any use or reproduction of these plans, in whole or in part, without the written permission of Solar Innovations, Inc. is forbidden.



SI3250N G2 Narrow NonThermal Folding Glass Wall, Infold, Top/Bottom Load, Standard Dual Wheel Sill

ALL DATA CONTAINED HERE IN IS CONSIDERED COMPANY CONFIDENTIAL INFORMATION AND IS SUBJECT TO OUR CONFIDENTIALITY AGREEMENT AS SET FORTH ON OUR WEBSITE AT <http://www.solarinnovations.com/contact/>

ALL DRAWINGS
ARE VIEWED
FROM THE
EXTERIOR
LOOKING IN.

DRAWING
SCALE:
NOT TO SCALE

© 2017 Solar Innovations® Architectural Glazing Systems – All Rights Reserved. These plans are the property of Solar Innovations® Architectural Glazing Systems. Any use or reproduction of these plans, in whole or in part, without the written permission of Solar Innovations® Architectural Glazing Systems is forbidden.

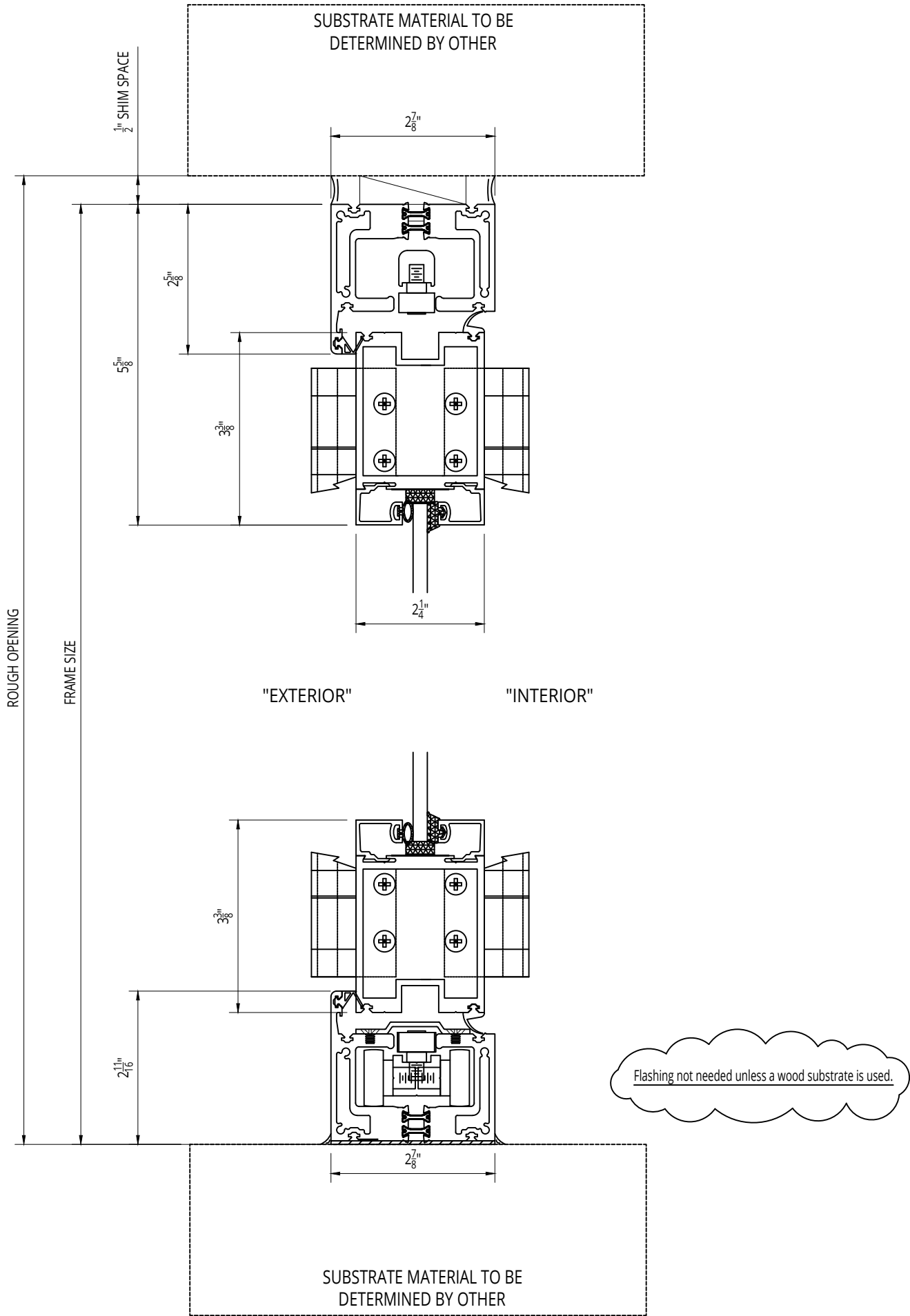

© 2017 Solar Innovations, Inc. - All Rights Reserved. These plans are the property of Solar Innovations, Inc. Any use or reproduction of these plans, in whole or in part, without the written permission of Solar Innovations, Inc. is forbidden.



SOLAR INNOVATIONS®
WINDOWS & DOORS

SI3250N G2 Narrow NonThermal Folding Glass Wall, Infold,
Bottom Load, Standard Dual Wheel Sill - Head and Sill Section

ALL DATA CONTAINED HERE IN IS CONSIDERED COMPANY CONFIDENTIAL INFORMATION AND IS SUBJECT TO OUR CONFIDENTIALITY AGREEMENT AS SET FORTH ON OUR WEBSITE AT <http://www.solarinnovations.com/contact/>

ALL DRAWINGS
ARE VIEWED
FROM THE
EXTERIOR
LOOKING IN.

DRAWING
SCALE:
NOT TO SCALE

© 2017 Solar Innovations® Architectural Glazing Systems – All Rights Reserved. These plans are the property of Solar Innovations® Architectural Glazing Systems. Any use or reproduction of these plans, in whole or in part, without the written permission of Solar Innovations® Architectural Glazing Systems is forbidden.

STRUCTURAL HEADER NOTE:
STRUCTURAL HEADER [NOT BY SOLAR INNOVATIONS]
REQUIRED TO SUPPORT WEIGHT OF FOLDING GLASS WALL.
HEAD DETAIL SHOWN FOR CONCEPTUAL USE ONLY. DESIGN OF
HEADER IS NOT THE RESPONSIBILITY OF SOLAR INNOVATIONS.

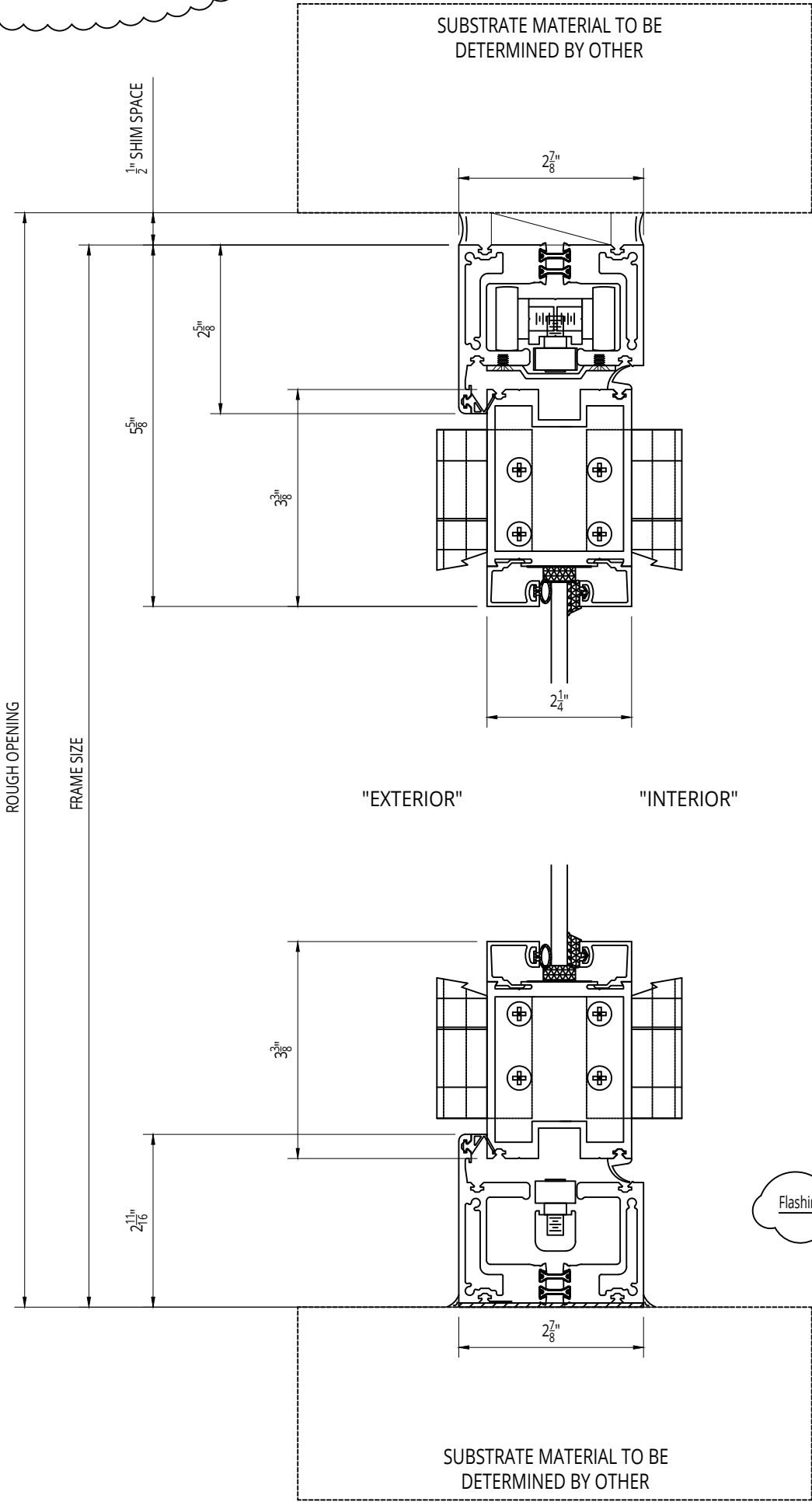

Flashing not needed unless a wood substrate is used.

© 2017 Solar Innovations, Inc. - All Rights Reserved. These plans are the property of Solar Innovations, Inc. Any use or reproduction of these plans, in whole or in part, without the written permission of Solar Innovations, Inc. is forbidden.



SOLAR INNOVATIONS®
WINDOWS & DOORS

SI3250N G2 Narrow NonThermal Folding Glass Wall, Infold,
Top Load, Standard Dual Wheel Sill- Head and Sill Section

ALL DATA CONTAINED HERE IN IS CONSIDERED COMPANY CONFIDENTIAL INFORMATION AND IS SUBJECT TO OUR CONFIDENTIALITY AGREEMENT AS SET FORTH ON OUR WEBSITE AT <http://www.solarinnovations.com/contact/>

ALL DRAWINGS
ARE VIEWED
FROM THE
EXTERIOR
LOOKING IN.

DRAWING
SCALE:
NOT TO SCALE

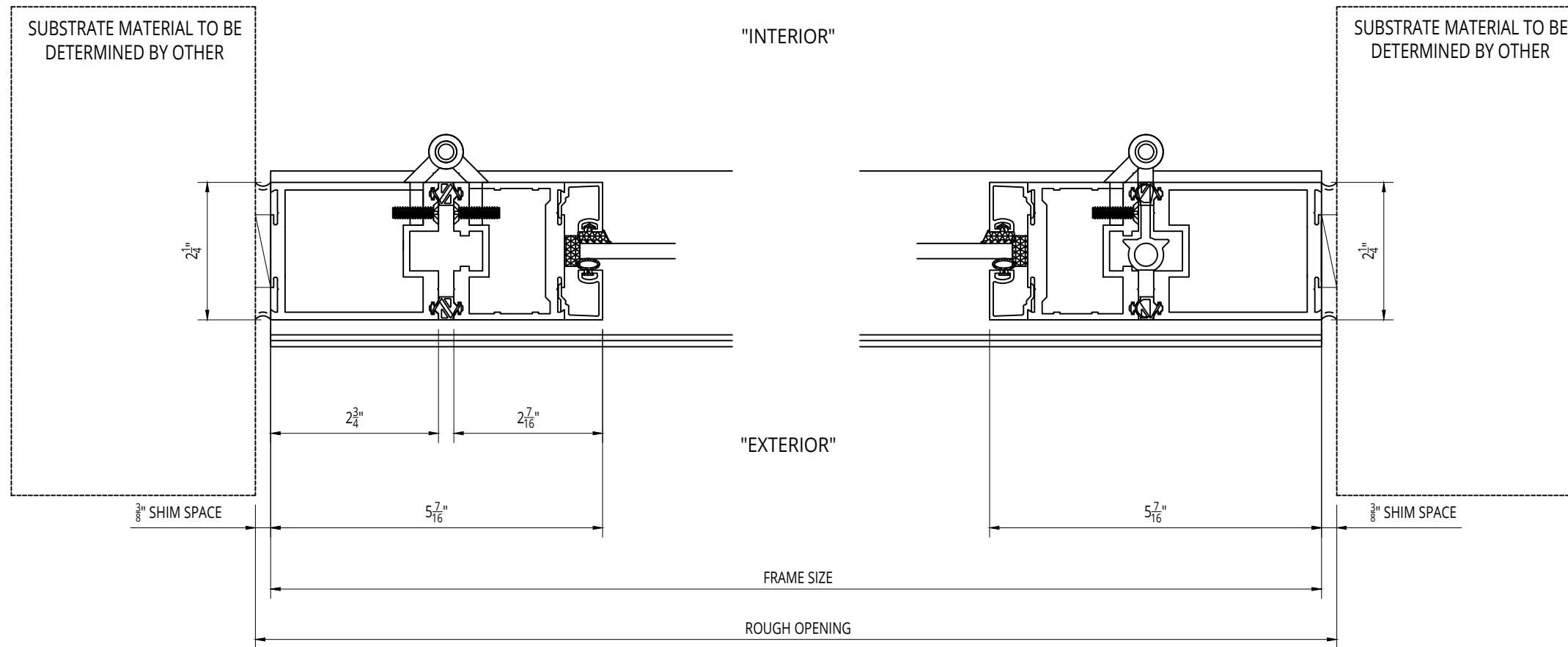

© 2017 Solar Innovations, Inc. - All Rights Reserved. These plans are the property of Solar Innovations, Inc. Any use or reproduction of these plans, in whole or in part, without the written permission of Solar Innovations, Inc. is forbidden.



SI3250N G2 Narrow NonThermal Folding Glass Wall, Infold, Top/Bottom Load, Standard Dual Wheel Sill - Jamb Details

ALL DATA CONTAINED HERE IN IS CONSIDERED COMPANY CONFIDENTIAL INFORMATION AND IS SUBJECT TO OUR CONFIDENTIALITY AGREEMENT AS SET FORTH ON OUR WEBSITE AT <http://www.solarinnovations.com/contact/>

ALL DRAWINGS
ARE VIEWED
FROM THE
EXTERIOR
LOOKING IN.

DRAWING
SCALE:
NOT TO SCALE

SI3250N G2 FOLDING GLASS WALL SILLS

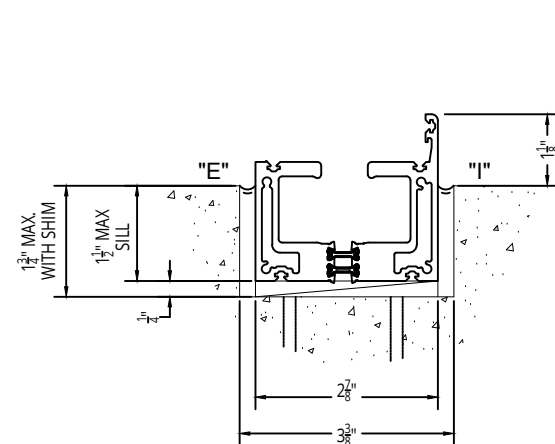

RECESSED STANDARD SILL
12.0 PSF NO LEAKAGE
HURRICANE CERTIFIED
NOT ADA
MUST CHOOSE PAINT COLOR

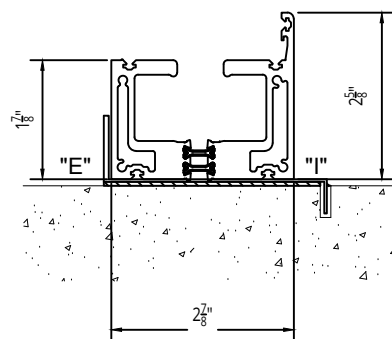

STANDARD SILL
12.0 PSF NO LEAKAGE
HURRICANE CERTIFIED
NOT ADA
MUST CHOOSE PAINT COLOR

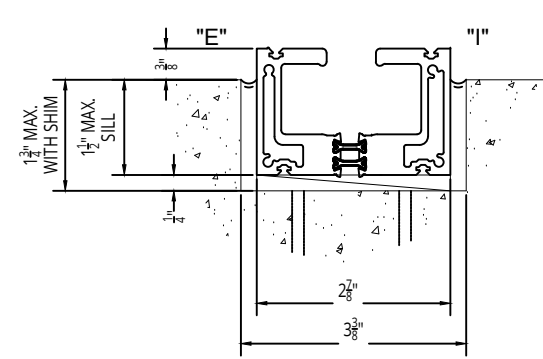

RECESSED FLUSH SILL
LIMITED AIR & WATER PERFORMANCE
SIMILAR TO COMMERCIAL DOOR OR BETTER
BECAUSE OF TANK
HURRICANE CERTIFIED AT 9.0PSF NO LEAKAGE
CLR OR DK BRZ ANODIZED

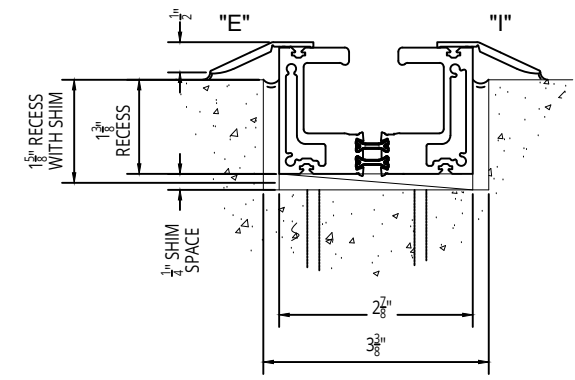

RECESSED SILL w/ DOUBLE ADJUSTABLE RAMP STOP
LIMITED WATER RESISTANCE SIMILAR
TO COMMERCIAL DOOR
HURRICANE CERTIFIED
MEETS ADA
CLR OR DK BRZ ANODIZED

TOP LOAD ONLY (REQUIRES STRUCTURAL HEADER BY OTHERS) NO TRANSOM BY S.I.

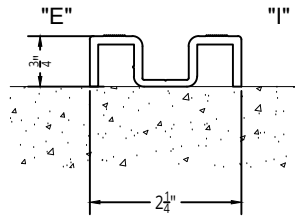

SURFACE MOUNTED SILL (TOP LOAD ONLY)
LIMITED AIR AND WATER
SIMILAR TO COMMERCIAL DOOR
NOT HURRICANE CERTIFIED
MUST CHOOSE PAINT COLOR

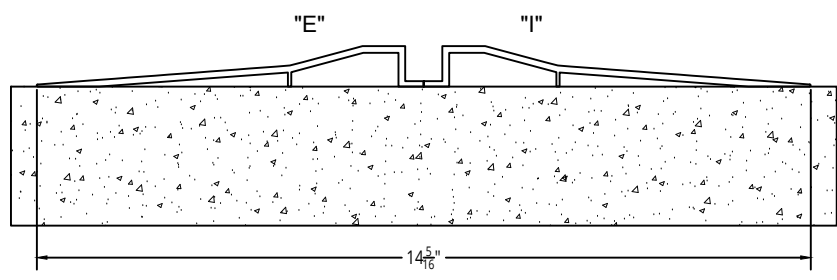

SURFACE MOUNTED SILL (TOP LOAD ONLY)
LIMITED WATER RESISTANCE SIMILAR
TO COMMERCIAL DOOR
MEETS ADA
NOT HURRICANE CERTIFIED
CLR OR DK BRZ ANODIZED

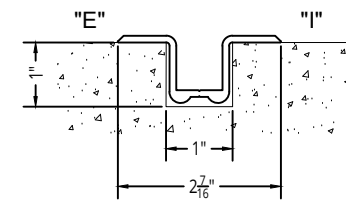

RECESSED FLUSH HAT SILL (TOP LOAD ONLY)
LIMITED TO NO WATER RESISTANCE
MEETS ADA
NOT HURRICANE CERTIFIED
CLR OR DK BRZ ANODIZED

PLEASE NOTE: All recessed sills require a 1 1/2" drain pipe to be located at two points under the sill.
Locations to be determined and show on shop drawings.

© 2017 Solar Innovations, Inc. - All Rights Reserved. These plans are the property of Solar Innovations, Inc. Any use or reproduction of these plans, in whole or in part, without the written permission of Solar Innovations, Inc. is forbidden.



SI3250N G2 Narrow NonThermal Folding Glass Wall - Sill Options

ALL DATA CONTAINED HERE IN IS CONSIDERED COMPANY CONFIDENTIAL INFORMATION AND IS SUBJECT TO OUR CONFIDENTIALITY AGREEMENT AS SET FORTH ON OUR WEBSITE AT <http://www.solarinnovations.com/contact/>

ALL DRAWINGS
ARE VIEWED
FROM THE
EXTERIOR
LOOKING IN.

DRAWING
SCALE:
NOT TO SCALE