

EXTERIOR ELEVATION

~ SOLAR INNOVATIONS' MULTI-TRACK SLIDER ~

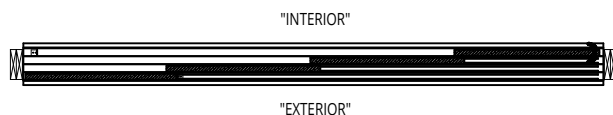

PLAN VIEW - PANELS CLOSED

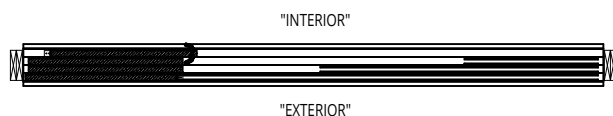

PLAN VIEW - PANELS OPEN

UNIT INFORMATION

FRAMING TYPE: G2 Hurricane Hook Rail with Fill and Debridge Thermal Break, 3" Stainless Steel Rollers

GLAZING SET UP: Opening for $\frac{3}{16}$ " Monolithic Glazing to 1" Insulated Glazing, Polycarbonate, or Solid Panel Infill

Decorative interior and exterior low profile grid option.

Motorized Panels Possible

Minimum Horizontal Panel Dimension 18". Smaller Panels may be available upon Engineering Approval

Designed and Manufactured in the U.S.A.

© 2017 Solar Innovations, Inc. - All Rights Reserved. These plans are the property of Solar Innovations, Inc. Any use or reproduction of these plans, in whole or in part, without the written permission of Solar Innovations, Inc. is forbidden.

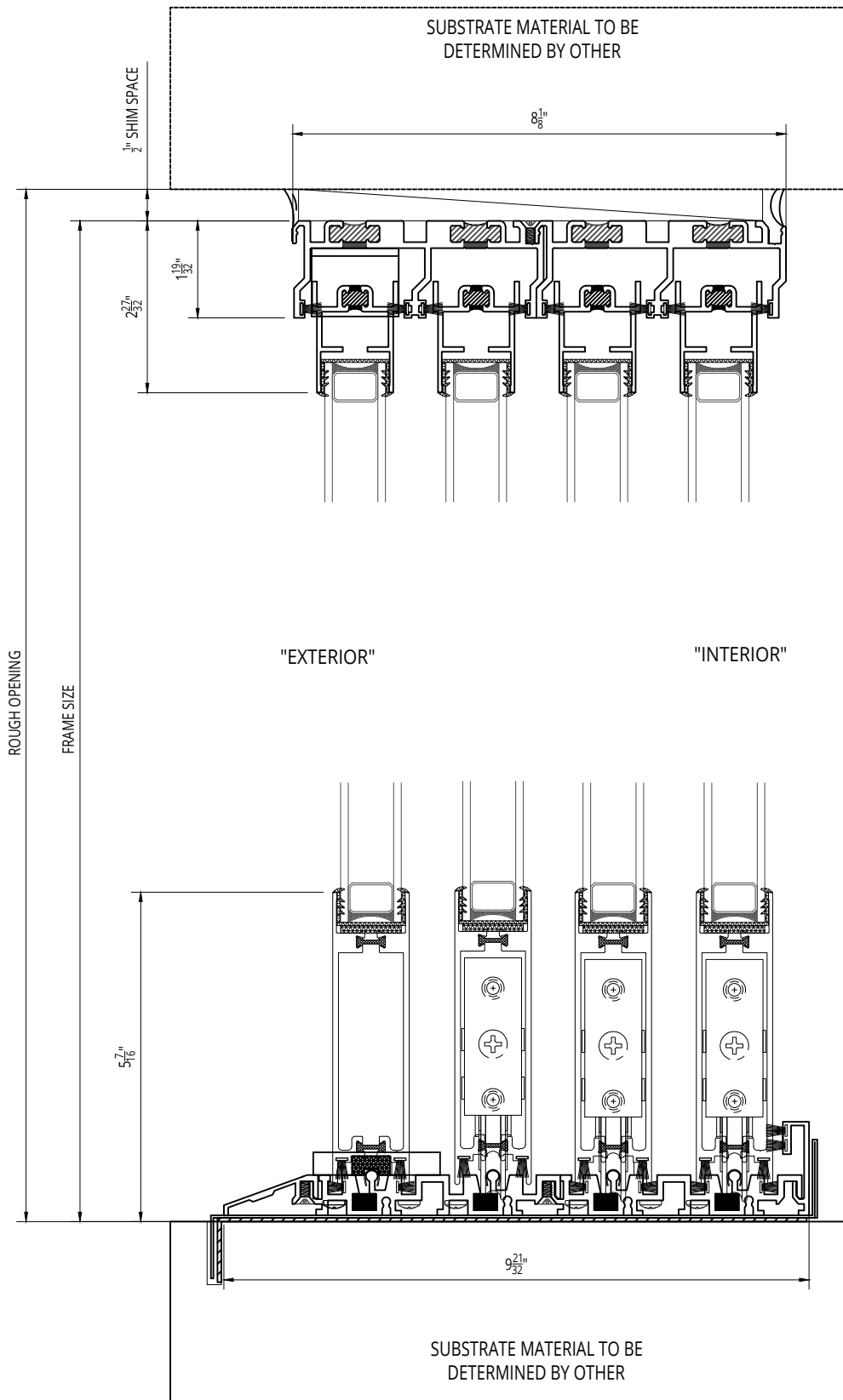

© 2017 Solar Innovations, Inc. - All Rights Reserved. These plans are the property of Solar Innovations, Inc. Any use or reproduction of these plans, in whole or in part, without the written permission of Solar Innovations, Inc. is forbidden.



SOLAR INNOVATIONS
WINDOWS & DOORS

SI8000 G2 Thermally Broken Sliding Glass Door, Hurricane
Hook Rail, HP Sill, 3" S.S. Rollers - Head and Sill Section

ALL DRAWINGS
ARE VIEWED FROM
THE EXTERIOR
LOOKING IN.

DRAWING
SCALE:
NOT TO SCALE

ALL DATA CONTAINED HEREIN IS CONSIDERED COMPANY CONFIDENTIAL INFORMATION AND IS SUBJECT TO OUR CONFIDENTIALITY AGREEMENT AS SET FORTH ON OUR WEBSITE AT <http://www.solarinnovations.com/contact/>

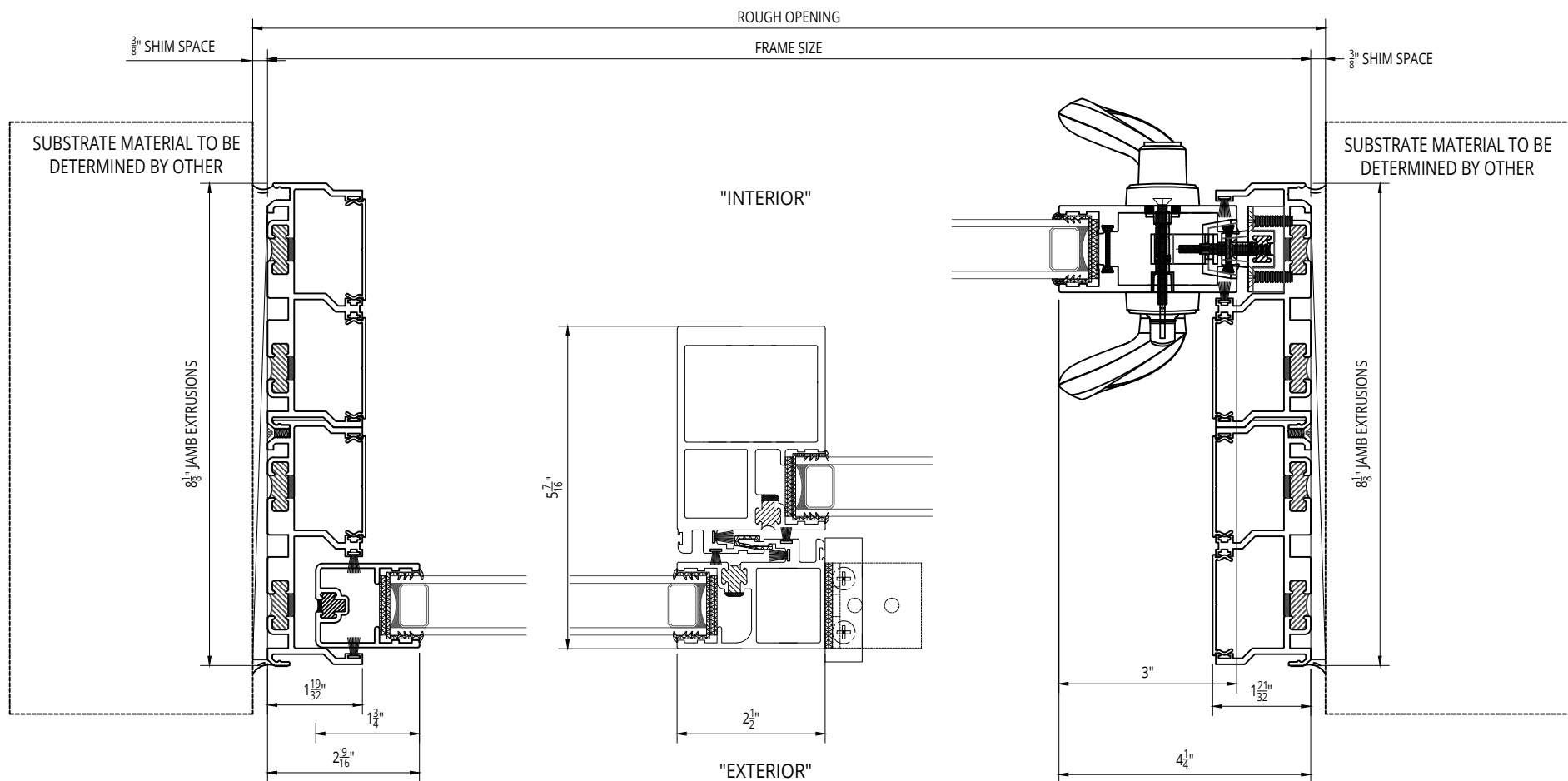

© 2017 Solar Innovations, Inc. - All Rights Reserved. These plans are the property of Solar Innovations, Inc. Any use or reproduction of these plans, in whole or in part, without the written permission of Solar Innovations, Inc. is forbidden.



SOLAR INNOVATIONS
WINDOWS & DOORS

S18000 G2 Thermally Broken Sliding Glass Door, Hurricane Hook Rail, HP Sill, 3" S.S. Rollers - Jamb Details

ALL DATA CONTAINED HERE IN IS CONSIDERED COMPANY CONFIDENTIAL INFORMATION AND IS SUBJECT TO OUR CONFIDENTIALITY AGREEMENT AS SET FORTH ON OUR WEBSITE AT <http://www.solarinnovations.com/contact/>

ALL DRAWINGS
ARE VIEWED
FROM THE
EXTERIOR
LOOKING IN.

DRAWING
SCALE:
NOT TO SCALE

SI8000 GEN 2 MULTI TRACK SLIDING DOOR SILLS

Thermally Broken Sill Options

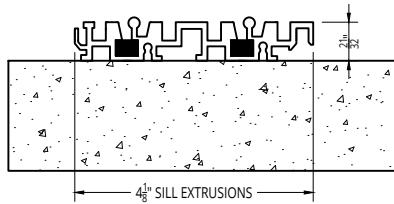

**THERMALLY BROKEN
LOW PROFILE MULTI TRACK SLIDING
DOOR SILL**
LIMITED TO NO AIR OR WATER
CLR OR DK BRZ ANODIZED

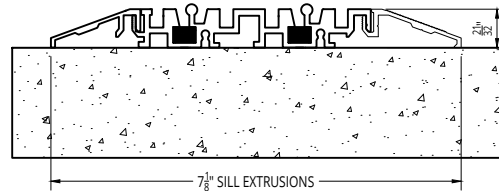

**THERMALLY BROKEN
LOW PROFILE MULTI TRACK SLIDING DOOR
SILL w/ INTERIOR AND EXTERIOR RAMP**
MEETS ADA REQUIREMENTS
LIMITED TO NO AIR OR WATER
CLR OR DK BRZ ANODIZED

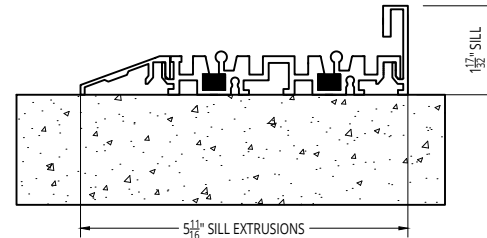

**THERMALLY BROKEN
HIGH PERFORMANCE MULTI TRACK
SLIDING DOOR SILL**
CLR OR DK BRZ ANODIZED

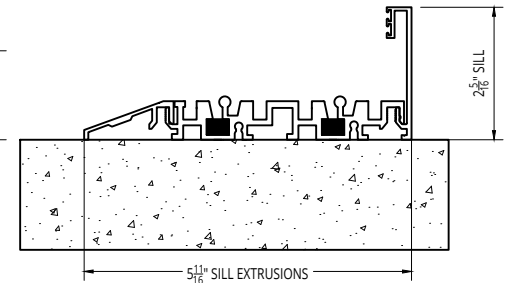

**THERMALLY BROKEN
EXTRA HIGH PERFORMANCE MULTI
TRACK SLIDING DOOR SILL**
CLR OR DK BRZ ANODIZED

Non-Thermally Broken Sill Options

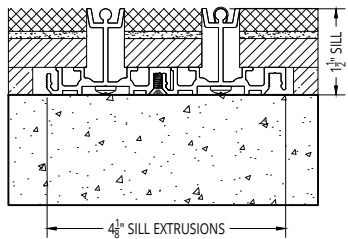

**NON-THERMAL
MULTI TRACK SLIDING TILE SILL**
MEETS ADA REQUIREMENTS IF INSTALLED AS
SHOWN
CLR OR DK BRZ ANODIZED



**NON-THERMAL LOW PROFILE MULTI
TRACK SLIDING DOOR SILL**
LIMITED TO NO AIR OR WATER
CLR OR DK BRZ ANODIZED

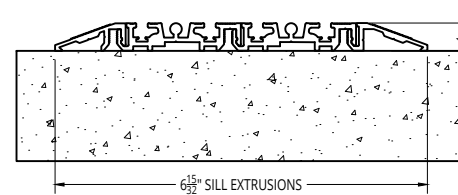

**NON-THERMAL LOW PROFILE MULTI
TRACK SLIDING DOOR SILL w/
INTERIOR AND EXTERIOR RAMP**
MEETS ADA REQUIREMENTS
LIMITED TO NO AIR OR WATER
CLR OR DK BRZ ANODIZED

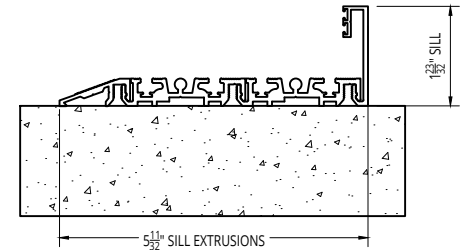

**NON-THERMAL
HIGH PERFORMANCE MULTI TRACK
SLIDING DOOR SILL**
CLR OR DK BRZ ANODIZED

© 2017 Solar Innovations, Inc. - All Rights Reserved. These plans are the property of Solar Innovations, Inc. Any use or reproduction of these plans, in whole or in part, without the written permission of Solar Innovations, Inc. is forbidden.